



BELGO[®]

BEARINGS

**HIGH-SPEED ROTOR SPINDLES
& TEXTILE BEARINGS**
PRECISION ENGINEERING FOR OPEN-END SPINNING EFFICIENCY



BELGO INDUSTRY | Engineered in Belgium

GO FOR REVOLUTIONARY ENGINEERING!

Global Production With 15+ Years Of Expertise

A GLOBAL COMMITMENT TO QUALITY

Belgo Bearings, based in Belgium, operates with over 15 years of industry expertise. Our products are engineered and manufactured according to stringent ISO and DIN quality standards across our global production centers.

From raw material selection to final testing, our advanced technology and expert engineering team ensure superior quality, minimizing maintenance and maximizing operational uptime.



BELGO[®]
INDUSTRY



OUR VALUE PROPOSITION

- * **Reliability:** Built on a foundation of high-quality products and service.
- * **Efficiency:** Optimized for competitive lead times and reduced purchasing costs.
- * **Expertise:** Specialist knowledge in design, material



GO for REVOLUTIONARY ENGINEERING

www.belgo-bearings.com
www.belgo-industry.com

This document contains a general overview of the products and features described here in. All rights reserved to Belgo® Bearings and Belgo Industry

GLOBAL REACH, STRATEGIC PRESENCE



HEAD OFFICE
BELGIUM



SWITZERLAND



CZECH REPUBLIC



SOUTH KOREA

Headquartered in the heart of Europe (Brussels, Belgium), Belgo Industry operates through a strategic network of production and distribution hubs across Switzerland, the Czech Republic, and South Korea.

This global footprint allows us to combine European engineering precision with rapid logistical capabilities, ensuring that our partners worldwide receive critical components with minimal lead times.

STATE-OF-THE-ART MANUFACTURING

Quality is not just inspected; it is engineered. Our production facilities are equipped with advanced CNC technology and operated by highly skilled specialists dedicated to perfection.

From raw material selection to final grinding, every Belgo bearing undergoes rigorous quality control protocols to meet the demanding tolerances required by modern textile machinery. We don't just build bearings; we engineer reliability.



GO for REVOLUTIONARY ENGINEERING

www.belgo-bearings.com
www.belgo-industry.com

This document contains a general overview of the products and features described here in. All rights reserved to Belgo® Bearings and Belgo Industry

HIGH-PERFORMANCE ROTOR CUPS

Optimized Surface Geometries & Diamond Coating Technology

Spinning Components

Yarn quality is defined where the fiber meets the rotor groove.

Belgo Rotor Cups are manufactured with ultra-precise tolerances to ensure smooth fiber flow and optimal twist insertion.

Nomenclature System

Nomenclature SystemDesign Note:
Create a simple visual breakdown like:

[B] - [T] - [34] - [DN]

- B: Belgo Series
- T: Groove Profile (T, Z, U)
- 34: Cup Diameter (mm)
- DN: Coating Type



Adapter Series

Visual Breakdown:
[B] - [C5] - [33] - [DN]

- B: Belgo Series
- C5: Adapter Type
(Machine Specific)
- 33: Cup Diameter (mm)
- DN: Coating Type



Surface Technologies (Coatings)

Type	Code	Application
Diamond	D	Extreme hardness for abrasive fibers (Polyester, Recycled).
Diamond-Nickel	DN	Balanced corrosion resistance with smooth surface finish.
Anodized	E	Cost-effective solution for standard cotton applications.

Groove Geometries & Application

1- T-PROFILE (Universal)

- *Application: Cotton, Viscose, Blends.
- *Benefit: The industry standard. Provides a balanced yarn structure with high strength

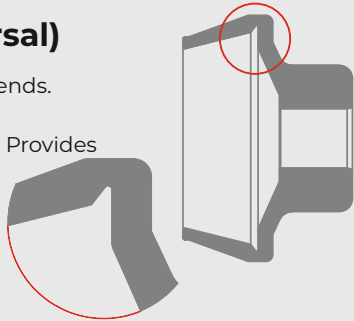

2- Z-PROFILE (Synthetics)

- * Application: 100% Man-Made Fibers (MMF), Acrylic.
- * Benefit: Narrow groove design increases spinning stability for slippery synthetic fibers.

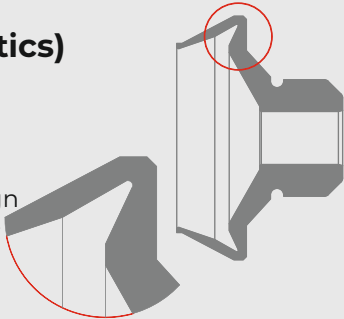

3- U-PROFILE (Coarse/Bulk)

- *Application: Denim, Coarse Counts (Ne < 10).
- *Benefit: Wide groove allows better dust removal and creates high-bulk yarns

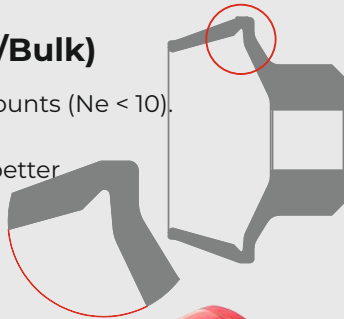

COMPATIBLE WITH SAURER BD, RIETER BT/R, AND TAITAN TQF SERIES.

COMPLETE ROTOR ASSEMBLIES

Precision Balanced & Ready-to-Install Solutions for OE Frames

Balancing Standard:All complete rotor assemblies are dynamically balanced according to ISO 1940-1 (Grade G 2.5). This ensures:

- * Reduced noise levels.
- * Extended bearing life.
- * Consistent yarn quality at peak speeds.

Custom configurations available upon request.

Plug & Play Systems

Compatible with SAURER

Engineered for Saurer BD 3XX, 4XX, BD 6/7/8 & Autocoro Series. Supplied as dynamically balanced sets to ensure vibration-free running up to 105,000 RPM.

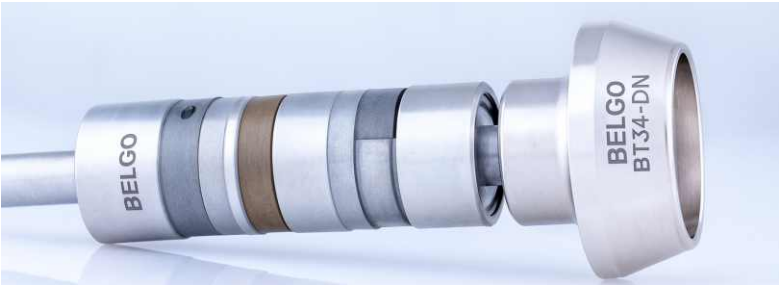

Bearing Unit	Speed Range (RPM)	Compatible Belgo Cup Types
B-73-1-22	25,000 - 45,000	B-Z66-DN / B-T66-DN
B-73-1-22	40,000 - 60,000	B-Z54-DN / B-T50-DN
B-T004	55,000 - 75,000	B-T46-DN / B-T43-DN
B-T010	75,000 - 105,000	B-T34-DN / B-T34-D
B-T100	105,000 - 110,000	B-T34-DN (High Speed)

Compatible with RIETER

Engineered for Rieter BT 923, R 923, R35, R36 & R37 Series. Features the specific "C-Type" adapter interface for precise fitment and stability.



Bearing Unit	Speed Range (RPM)	Compatible Belgo Cup Types
B-73-1-52	40,000 - 60,000	B-C254 U-D / B-S254 U-D
B-T013	60,000 - 75,000	B-C341 U-D / B-S341 T-D
B-T013	75,000 - 95,000	B-C536 U-D / B-S536 U-D
B-72-11	80,000 - 105,000	B-C533 U-D / B-S533 Tr-D

Bearing

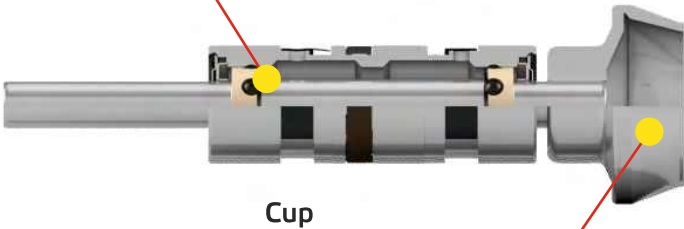

Cup

Bearing

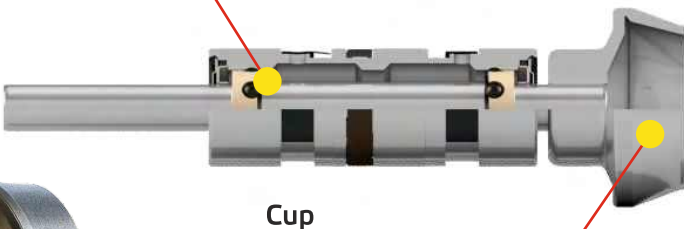

Cup

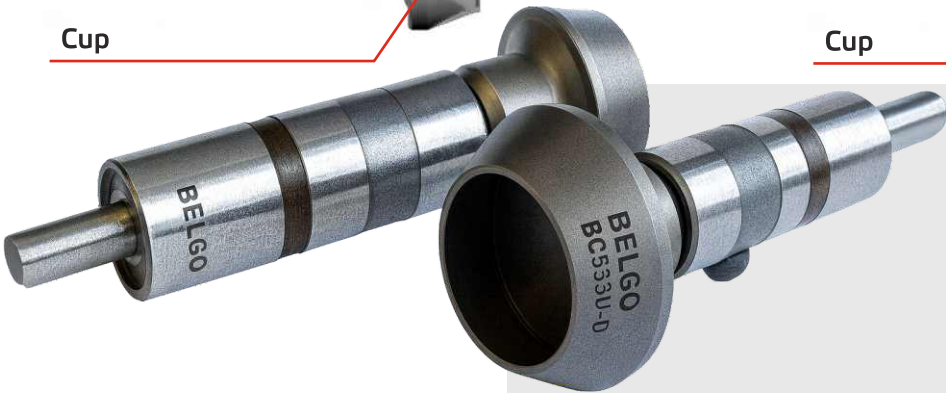

NOTE: BELGO ROTOR CUPS ARE COMPATIBLE WITH ALL BELGO ROTOR BEARING UNITS AND MAJOR OEM SPINNING BOXES (SAURER, RIETER, TAITAN).

SPECIALIZED ROTOR ASSEMBLIES

Solutions for Asian OEM Frames & Legacy Machines

Balancing Standard:All complete rotor assemblies are dynamically balanced according to ISO 1940-1 (Grade G 2.5). This ensures:

- * Reduced noise levels.
- * Extended bearing life.
- * Consistent yarn quality at peak speeds.

Custom configurations available upon request.

Specific Applications

Compatible with TAITAN & RIFA

Engineered for Taitan TQF (368/568/K-80) and Rifa (RS51/RS30) Series. High-stability bearing units designed for speeds up to 105,000 RPM



Bearing Unit	Speed Range (RPM)	Compatible Belgo Cup Types
B-73-1-22	25k - 45k	B-Z66-DN / B-T66-DN
B-T004	55k - 75k	B-T46-DN / B-L54-DN
B-T010	75k - 105k	B-T34-DN / B-T34-DNTI
B-T100	105k - 110k	B-T34-DN (High Speed)

Note: Titanium coating options (DNTI) available for extreme wear conditions.

Compatible with LEGACY MACHINES

Application: Maintenance solutions for BD 200 (RCE/RN/SN) and BD A 10/20 Series. Designed to extend the operational life of legacy spinning lines.



Bearing Unit	Speed Range (RPM)	Compatible Belgo Cup Types
B-73-1-22	25,000 – 45,000	B-E66 (Butterfly Vented)
B-73-1-22	40,000 – 60,000	B-E54 (Vented)
B-73-1-31	60,000 – 80,000	B-E40 (Vented)
B-72-6	70,000 – 90,000	B-E36 (Vented)

Bearing

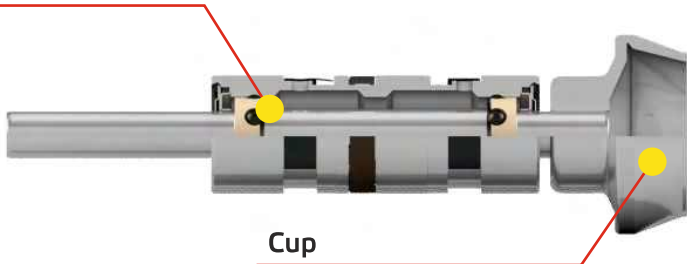

Cup

Bearing

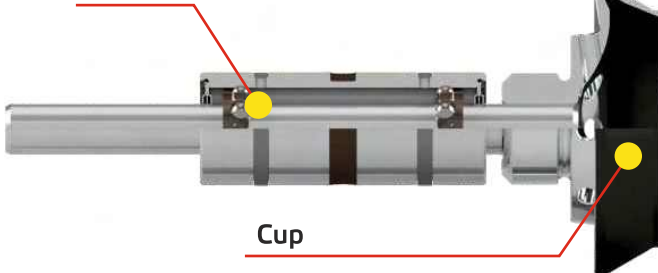

Cup

Important: These rotor cups feature ventilation holes to match the airflow dynamics of older generation spin boxes.

Legacy Support: Belgo Industry is committed to supporting older machine generations with premium spare parts, ensuring your established production lines remain profitable.

COMPATIBILITY: DIRECTLY INTERCHANGEABLE WITH ORIGINAL PARTS FOR TAITAN, RIFA, AND BD 200 SERIES.

SPECIALIZED ROTOR ASSEMBLIES

Solutions for Asian OEM Frames & Legacy Machines

Specific Applications

Asian OEM Compatible

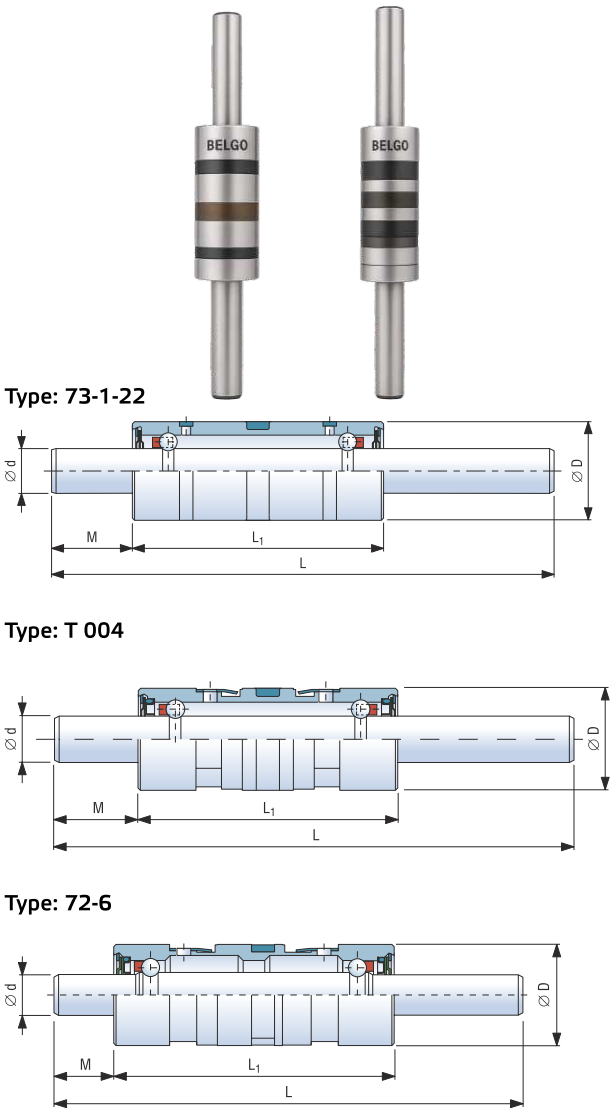

Legacy Machine Compatible

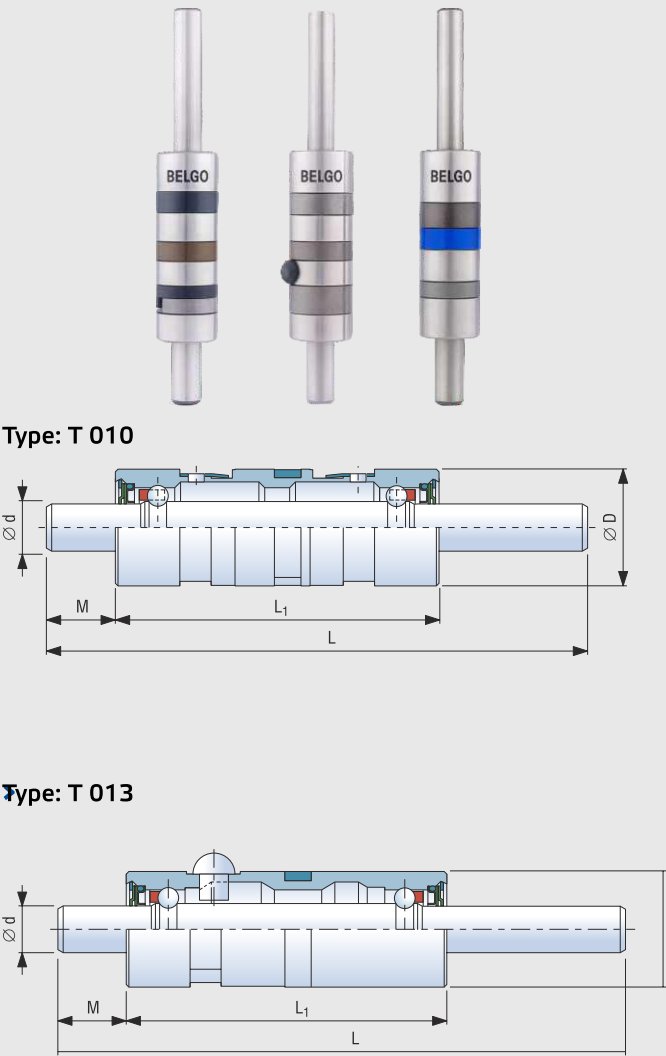

SPECIALIZED COMPATIBILITY MATRIX

Machine Type	OEM Model Ref.	Bearing Unit	Speed Limit	Compatible Cup Type	Note
Asian OEM	Taitan TQF / Rifa RS	B-73-1-22	45,000	B-Z66-DN / B-T66-DN	STD
Asian OEM	Taitan TQF / Rifa RS	B-T004	75,000	B-T46-DN / B-L54-DN	-
Asian OEM	Taitan TQF / Rifa RS	B-T010	105,000	B-T34-DN / B-T34-DNTI	High Speed
Legacy	BD 200 RCE/RN/SN	B-73-1-22	45,000	B-E66 (Ventilated)	Air Cooled
Legacy	BD SD / D1 / D2	B-73-1-22	60,000	B-E54 (Ventilated)	-
Legacy	BD A 10/20	B-73-1-31	80,000	B-E40 (Ventilated)	Short Shaft
Legacy	BT 902 / 903	B-72-6	90,000	B-E36 (Ventilated)	-

Type A (Asian OEM): Designed with reinforced bearing cages to match the higher vibration profiles of Taitan and Rifa frames.
Type B (Legacy): Features specific Ventilation Holes on the rotor cup to ensure correct negative pressure in older generation spin boxes.
Coating: Standard delivery in Diamond-Nickel (DN). Titanium (DNTI) coating available for abrasive applications.

OPENING ROLLER & PRESS PULLEY BEARINGS

High-Performance Components for Fiber Preparation & Yarn Tension

Auxiliary Spinning Parts

Opening Roller Bearings

High-speed combing units with advanced sealing (KK-Type)



Type: 76-3, 76-3KK

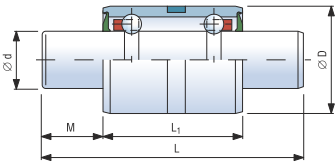

Type: T 763, 76-3-16, 76-3-17

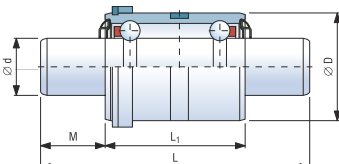

Type: 76-3-7, 76-3-7KK

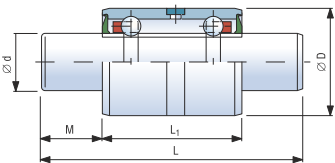

Press & Tension Pulleys

Precise yarn guiding and belt tensioning solutions.

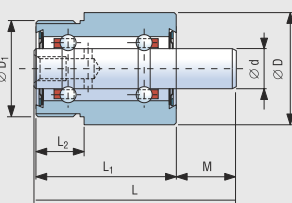

Type: 73-1-28, 73-1-49



Type: 76-3-1

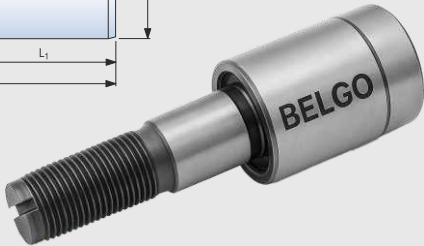
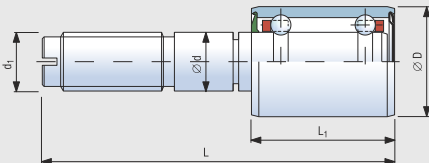

SPECIALIZED COMPATIBILITY MATRIX

Category	Belgo Type	Dimensions (d x D x L)	Speed Limit	Feature	Sealing
Opening Roller	B-76-3	16 x 30 x 73 mm	25,000 RPM	Standard	Open
Opening Roller	B-76-3KK	16 x 30 x 73 mm	25,000 RPM	Dust Proof	Metal Shield
Opening Roller	B-76-3-7	16 x 30 x 73 mm	25,000 RPM	Relubrication	Open
Opening Roller	B-T763	16 x 30 x 73 mm	30,000 RPM	High Speed	Metal Shield
Press Pulley	B-73-1-28	10 x 28 x 50.5 mm	15,000 RPM	Yarn Delivery	No
Press Pulley	B-73-1-49	10 x 28 x 54.5 mm	15,000 RPM	Extended Profile	No
Belt Tension	B-76-3-1	16 x 30 x 96 mm	10,000 RPM	Belt Tensioner	No

Technical Highlight: Our Opening Roller Bearings are designed to withstand the high centrifugal forces of the combing process. The specialized "KK" Metal Shield technology prevents fiber accumulation inside the bearing, preventing seizure and extending maintenance intervals.

Wire Compatibility: Compatible with all standard opening roller wires (OK40, OS21, etc.) and sleeves.

RESILIENT MOUNTING ELEMENTS

Vibration Damping Solutions for Rotor Bearing Housings

Anti-Vibration Series

High-Elasticity Mountings

Precision-ground steel sleeves with vulcanized elastomer inserts.



Type: 83-18-6, 83-18-10

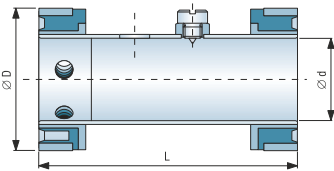

Type: 83-18-4

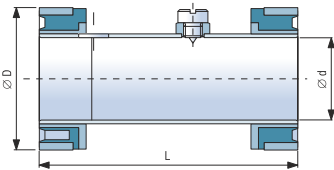

Type: 83-18-100

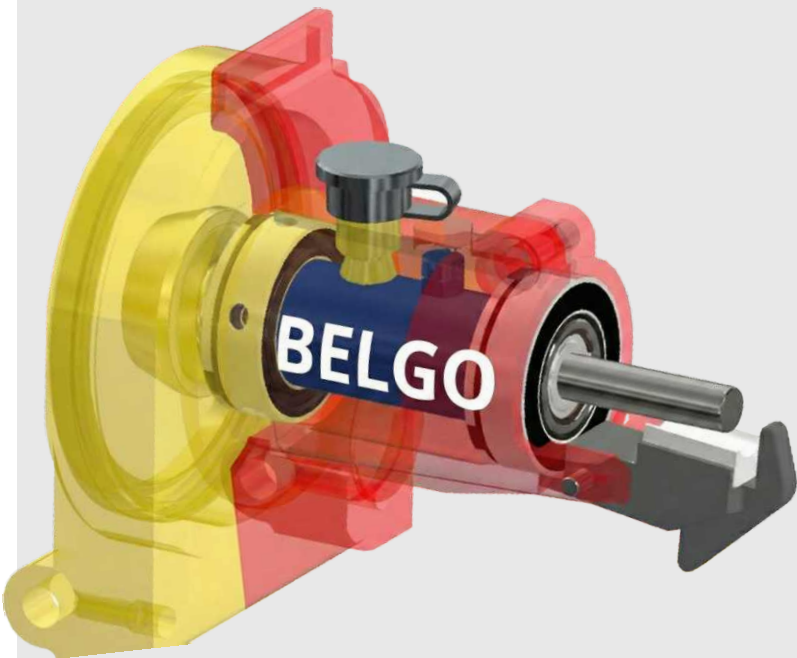
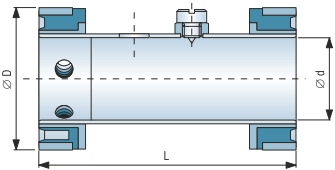

Selection & Compatibility Matrix

Belgo Ref.	Shaft Housing (ød)	Outer Dia (øD)	Length (L)	Speed Limit	Compatible Machine Models
B-83-18-6	22 mm	38 mm	69 mm	115,000	Rieter: BT 923, R 923, R35, R36, R37
B-83-18-10	22 mm	38 mm	69 mm	115,000	Rieter: BT 923, R 923, R35, R36, R37
B-83-18-4	22 mm	38 mm	70 mm	90,000	Saurer: BD 3/4/7 & Asian OEM: Taitan, Rifa, Jingwei
B-83-18-100	22 mm	38 mm	69 mm	105,000	Saurer: BD 3/4/7 & Asian OEM: Taitan, Rifa, Jingwei

Why Replace? Resilient mountings absorb high-frequency vibrations generated by rotors spinning at speeds over 100,000 RPM. Worn-out mountings lead to bearing overheating and yarn irregularity (CV%). We recommend replacing mountings with every new rotor bearing installation.

Quality Standard: Manufactured with oil-resistant elastomers and precision-ground steel to ensure perfect concentricity (< 0.01mm).



About Us

BELGO INDUSTRY BV is specialized in manufacturing high-quality industrial products for the needs of industrial applications.

Thanks to our advanced technology and specialization in industrial products, we provide high-quality solutions at affordable prices with optimized lead times.

We ensure you top-quality service for your industrial applications. You can always count on our expert advice and flexible service.

BELGO INDUSTRY BV – BELGIUM

Address: Excelsiorlaan 71, 1930
Zaventem Brussels – BELGIUM

Phone Number: +32 (0) 55 37 14 47

Fax: +32 (0) 55 37 14 47

E-Mail: info@belgo-industry.com

